

# 10275 Caledon Ct, Windsor, ON

Main Building: Total Exterior Area Above Grade 1350 sq ft

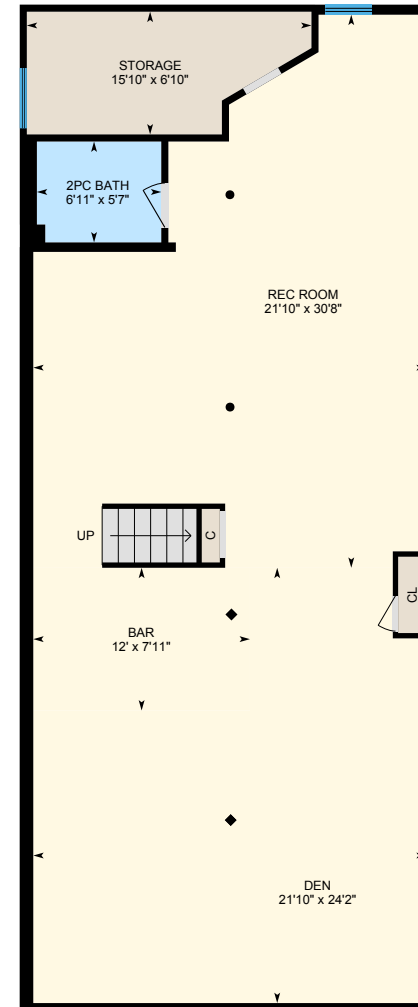

**Main Floor**  
Exterior Area 1350 sq ft



**Basement (Below Grade)**  
Exterior Area 1262 sq ft

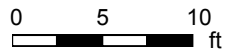

PREPARED: Jun, 2019

# 10275 Caledon Ct, Windsor, ON

Main Floor Total Exterior Area 1350 sq ft  
Total Interior Area 1287 sq ft

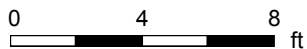

PREPARED: Jun, 2019



White regions are excluded from total floor area. All room dimensions and floor areas must be considered approximate and are subject to independent verification. For method of measurement please see <https://youriguide.com/measure/>.

# 10275 Caledon Ct, Windsor, ON

**Basement** Total Exterior Area 1262 sq ft  
Total Interior Area 1201 sq ft

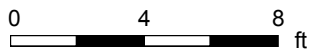
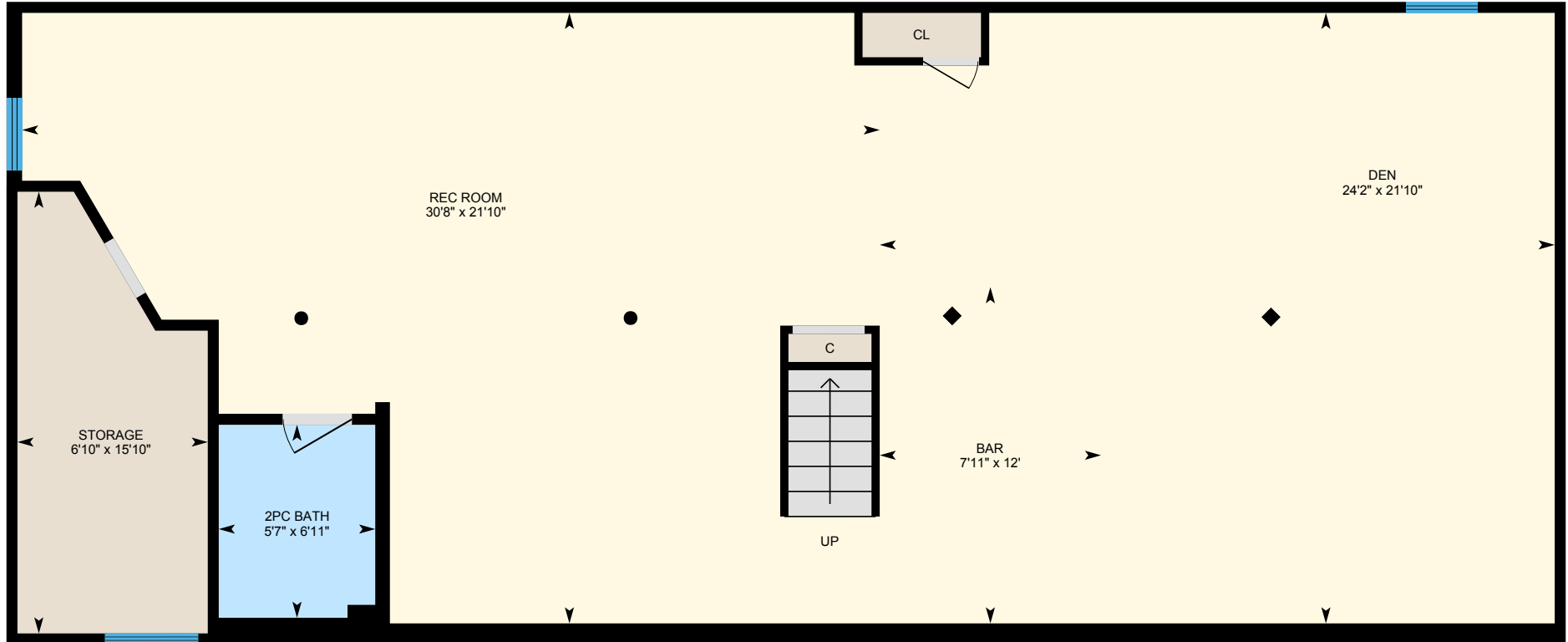

PREPARED: Jun, 2019



White regions are excluded from total floor area. All room dimensions and floor areas must be considered approximate and are subject to independent verification. For method of measurement please see <https://youriguide.com/measure/>.

# 10275 Caledon Ct, Windsor, ON

## Property Details

### Room Measurements

Only major rooms are listed. Some listed rooms may be excluded from total interior floor area (e.g. garage). Room dimensions are largest length and width; parts of room may be smaller. Room area is not always equal to product of length and width.

#### Main Building

##### MAIN FLOOR

3pc Ensuite: 6'4" x 6'9"  
4pc Bath: 8' x 7'3"  
Bedroom: 8'1" x 8'4"  
Bedroom: 8'11" x 11'5"  
Bedroom: 11'2" x 8'10"  
Dining: 11'2" x 14'4"  
Kitchen: 11'2" x 9'2"  
Living: 11'3" x 19'10"  
Master: 11'3" x 11'5"  
Utility: 5'7" x 5'11"

##### BASEMENT

2pc Bath: 6'11" x 5'7"  
Bar: 12' x 7'11"  
Den: 21'10" x 24'2"  
Rec Room: 21'10" x 30'8"  
Storage: 15'10" x 6'10"

### Floor Area Information

For explanation of floor area calculations and method of measurement please see <https://youriguide.com/measure/>.

#### Main Building

##### MAIN FLOOR

Interior Area: 1287 sq ft  
Perimeter Wall Length: 160 ft  
Perimeter Wall Thickness: 4.7 in  
Exterior Area: 1350 sq ft

##### BASEMENT (Below Grade)

Interior Area: 1201 sq ft  
Perimeter Wall Length: 156 ft  
Perimeter Wall Thickness: 4.7 in  
Exterior Area: 1262 sq ft

#### Total Above Grade Floor Area

Main Building Interior: 1287 sq ft  
**Main Building Exterior: 1350 sq ft**